

1987 to 1994 LT. WT.
 1987 to 1997 XL
 *1991 XL-BRKT. ADDED
 TO DRIVE UNITS TO
 PUT #9 DRIVE ROD
 UNDER THE FLOOR

CHAIN LIFT SYSTEM

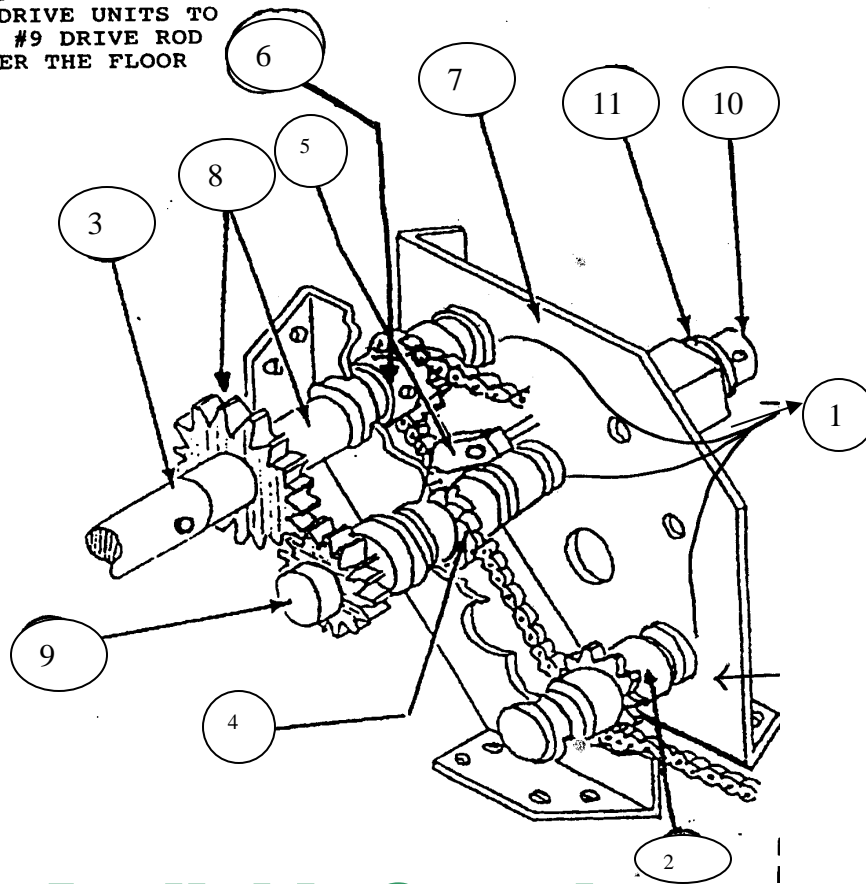

Not Available Complete

- | | |
|---------------------|---------|
| #1- LIFTER BEARINGS | L-66 |
| #2- TEN TOOTH GEAR | L-13 |
| #3- DRIVE ROD | 10-1426 |
| #4- RATCHET GEAR | L-14 |
| #5- RATCHET PAWL | L-15 |
| #6 - TEN TOOTH GEAR | L-13 |

Not Available Complete

- | | |
|------------------------------|---------|
| #7- FRONT DRIVE UNIT | |
| #8- 3" GEAR ON SHAFT | L-23 |
| #9- CLUTCH SHAFT DOUBLE GEAR | L-6 |
| #10- GEAR PINS | L-17 |
| #11- WASHERS—OLD | 10-L-16 |