

FULL SERVICE CENTER

Some of the services we provide for you are:

PARTS

We have the largest parts inventory in Southeastern Wisconsin.

APPLIANCE REPAIR

We service and sell all makes and models of RV appliances.

RV COACH SERVICE

RV BODY & PAINT

RV, TRAILER, SNOW PLOW, AND SALTER REPAIR



LOCATION



HANNA TRAILER SUPPLY

7575 South Howell Avenue
Oak Creek, WI 53154

Ph: 414.762.7950
Fx: 414.762.7904

HOURS

Monday – Friday
8:00 a.m. to 5:30 p.m.

Saturday
8:00 a.m. to 1:00 p.m.



HANNA TRAILER SUPPLY

7575 South Howell Avenue | Oak Creek, WI 53154
414.762.7950

www.hannaRV.com
PARTS & ACCESSORIES | SERVICE | RV INVENTORY | RENTALS | TRAILERS | SNOW PLOWS

RV RENTAL RATES & INFO

RV RENTALS EXPANDABLES

- 2011 CROSSOVER MODEL TLX-180T
- 2011 CROSSOVER MODEL TLX-190T

Renting a Recreational Vehicle offers many advantages for you and your family.

If you are considering the purchase of a RV, renting one will give you the chance to see if a recreational vehicle is right for you.

Does your lifestyle make it impractical to invest in a RV of your own? Renting a RV will allow you and your family to enjoy the benefits without the cost of purchasing.

BOOK EARLY TO ASSURE AVAILABILITY

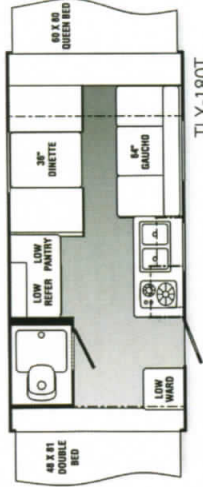

TLX-180T

2011 CROSSOVER Model TLX-180T

MODEL	GROSS VEHICLE WT RATING	DRY UNLOADED VEHICLE WT (APPR.)	NET CARRYING CAPACITY	EXTERIOR WIDTH W/O AWNING
TLX-180T	3,850 LBS.	2,854 LBS.	1,266 LBS.	7' 6"
OVERALL LENGTH	OVERALL HEIGHT INC. A/C	DRY HITCH WEIGHT (APPR.)	DRY AXLE WEIGHT (APPR.)	TIRE SIZE
19' 0"	9' 8"	326 LBS.	2,258 LBS.	14"
TIRE LOAD RANGE	FRESH WATER CAPACITY	FRONT BED AREA	REAR BED AREA	SLEEPING CAPACITY
C	30 GALS.	QUEEN BED	DOUBLE BED	8

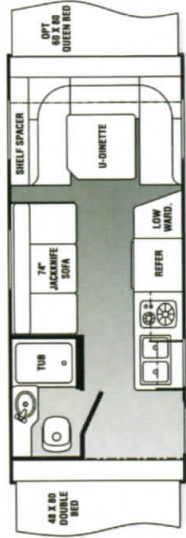

TLX-190T

2011 CROSSOVER Model TLX-190T

MODEL	GROSS VEHICLE WT RATING	DRY UNLOADED VEHICLE WT (APPR.)	NET CARRYING CAPACITY	EXTERIOR WIDTH W/O AWNING
TLX-190T	6,160 LBS.	3,144 LBS.	3,382 LBS.	7' 6"
OVERALL LENGTH	OVERALL HEIGHT INC. A/C	DRY HITCH WEIGHT (APPR.)	DRY AXLE WEIGHT (APPR.)	TIRE SIZE
21' 2"	9' 8"	333 LBS.	2,811 LBS.	14"
TIRE LOAD RANGE	FRESH WATER CAPACITY	FRONT BED AREA	REAR BED AREA	SLEEPING CAPACITY
C	30 GALS.	(OPT) QUEEN BED	DOUBLE BED	8

RENTAL RATE:

- 4 Night: (Required for Memorial/Labor Day/ 4th of July weekends) \$499 / \$125 Each additional night.
- 7 Night: \$725 / \$105 for each additional night.

4 day rental must be paid in full to make reservation and is **NON-REFUNDABLE.** (4 day rental only valid from Sept - May)

7 Night or longer rentals require a 50% **NON-REFUNDABLE** deposit at time of reservation, and remainder paid upon pick-up. Balance due 30 days before prior to rental.

Cancellation policy: All Deposits are **NON-REFUNDABLE.** Because we are a seasonal business and want to make sure we optimize the schedule, we want you to be sure of your time frame.

EXPANDABLE TRAVEL TRAILER RENTAL GUIDELINES:

- Units are cleaned before delivery, and are expected to be cleaned (INSIDE AND OUT) before return, if unit has not been cleaned the minimum cleaning fee is \$100
- No Pick-up or returns of rental units on Sundays or Holidays.
- No smoking or pets allowed in rental units
- \$500 damage deposit is held for 48 hours (no exceptions) following your return to cover any damage not readily seen. If unit is returned undamaged no charges will be made.
- Rental includes (2) Full 20lb. cylinders of LP gas. Upon return tanks will be refilled and you will be charged \$25 and the cost for gas.
- Expandable travel trailer requires a \$30 sanitation kit which includes (toilet chemical, (4) rolls toilet paper, new 10' sewer hose). Grey and Black water holding tanks must be emptied before return or a \$50 fee will incur.
- In order to rent you must be 25 years of age minimum, hold a valid drivers license, and have proof of automobile insurance.
- Units picked-up after 1 am and must be returned by 10 am.

9. Tow vehicle must have minimum 3,500 lb. tow rating for Model 180T and 4,000 lb. tow rating for Model 190T. Vehicle must be equipped with a minimum Class 3 receiver hitch and a flat 4-way electrical connector. Units are equipped with wireless brake controllers. There is a \$300 charge if wireless brake controller or hand held remote is lost or damaged.

10. 12 VDC battery is included with the rental.

11. You must notify your insurance agent of your intention to haul the trailer.

RV PACKAGES:

Executive Package: On return of trailer with the purchase of an executive package, Hanna Trailer and RV will clean the interior, wash the exterior, dump the holding tanks, and fill the propane tanks. The customer is still responsible for the cost of the Propane. All this for only \$150.

ADDITIONAL FEES AND CHARGES:

- Wash exterior: \$100
- Clean interior: \$100
- Unclog toilet: \$50
- Dump holding tanks: \$50
- Fill L.P. tanks: \$25 plus cost of L.P.